

NOW PRE-LEASING WESTWIND OUTLOT COMING FALL 2016

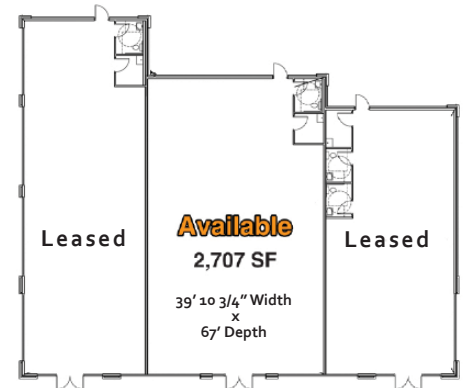

Address: TBD Rolling Meadows Dr. - Fond Du Lac, WI
On the Interstate 41 & Hwy 23 (Johnson St.) Exchange

Suites: 3

GLA: 6,795 Sq. Ft.

Dimensions:

Suite 1 : 2,283 Sq. Ft. (Leased)

Suite 2 : 2,707 Sq. Ft. (39' 10 3/4" Width x 67' Depth) (Available / Divisible)

Suite 3 : 1,805 Sq. Ft. (Leased)

Location Description: New construction outlot coming to the fully leased Westwind Shopping Center. Excellent visibility on a high traffic intersection in the Westside Fond Du Lac shopping district, and also on the Interstate 41 & Hwy 23 (Johnson St.) exchange.

Property Description: Central Retail / Office suite available in the outlot to the Westwind Shopping Center. Bring your new or expanding business to this excellent location and join Agnesian Healthcare, Sherwin Williams, Mattress Firm, Enterprise Rent-A-Car, & more.

Great Location and visibility on the corner of Hwy 23 (Johnson St.) & Rolling Meadows and the Interstate 41 Exchange

Traffic Counts: Johnson St: 23,200 VPD (2014)
Rolling Meadows: 6,300 VPD (2014)
Interstate 41: 34,500 VPD (2014)

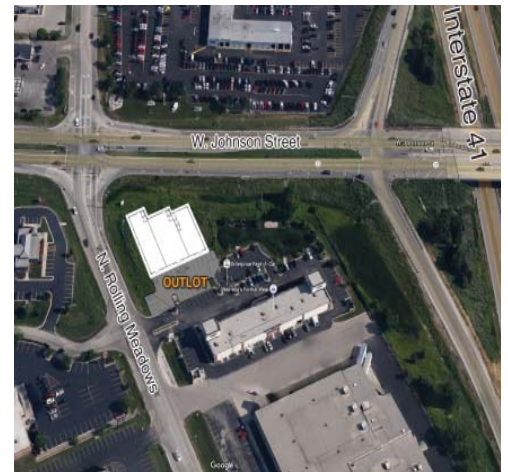

For More Information Contact:
Peter Jungbacker
(920) 233 - 7219 ext. 18
pjungbacker@alexanderbishop.com

