

# AVAILABLE

## WESTOWNE AVE.

2241 WESTOWNE AVE. - OSHKOSH, WI



Westowne Ave.



**Address:** 2241 Westowne Ave. - Oshkosh, WI

**Suite Number:** B

**Space:** 1,800 Sq. Ft.

**Dimensions:** 33.3' Width x 54' Depth

**Property Description:** 1,800 SF Retail suite available in Westowne Shopping Center co-tenanted by Cousins Subs. Bring your new or expanding business to the fast growing area of Oshkosh and join Dick's Sporting Goods, Lowes, Festival Foods Grocery, Menards, McDonalds, Culvers, Wendy's, Holliday Inn and more on Westowne Ave.

Great Location and visibility on Westowne Ave. parallel to Hwy 21

Traffic Counts: Westowne Ave. 6,300 VPD (2010)

Traffic Counts: Hwy 21 18,900 VPD (2009)

Oshkosh Population: 66,377 (2012)

Median Age: 33.9 years (2010)

Average HH Income: \$57,648 (2010)

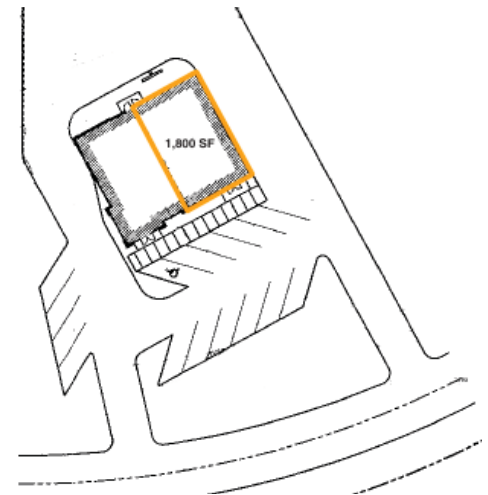

For More Information Contact:  
Peter Jungbacker  
(920) 233 - 7219 ext. 18  
[pjungbacker@alexanderbishop.com](mailto:pjungbacker@alexanderbishop.com)

